

## ULTRA 630DE-CO-M

### LOW-RISE COMMERCIAL LIFT

Capacity	630Kg – 8 persons
Max. Travel	18m / 6 levels
Pit Depth	900mm
Headroom	3300mm
Speed	0.63 m/s or 1.0 m/s
Doors	900mm x 2000mm – centre opening

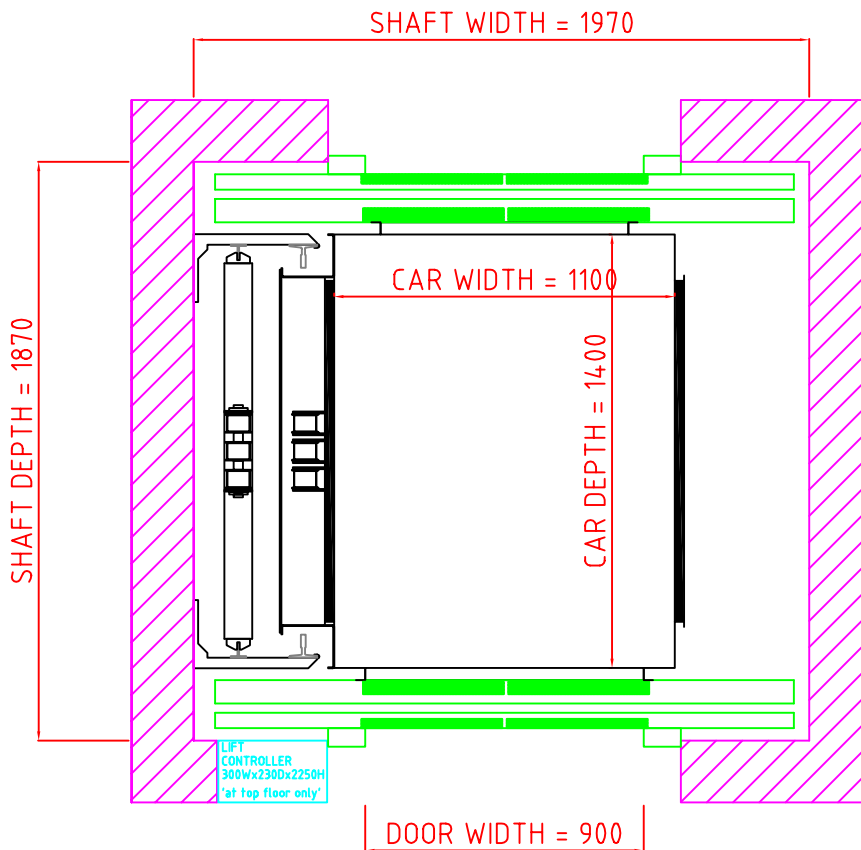

## ULTRA 630DE-CO-ST

### LOW-RISE COMMERCIAL LIFT WITH SUPPORTING STRUCTURE

Capacity	630Kg – 8 persons
Max. Travel	18m / 6 levels
Pit Depth	900mm
Headroom	3300mm
Speed	0.63 m/s or 1.0 m/s
Doors	900mm x 2000mm – centre opening

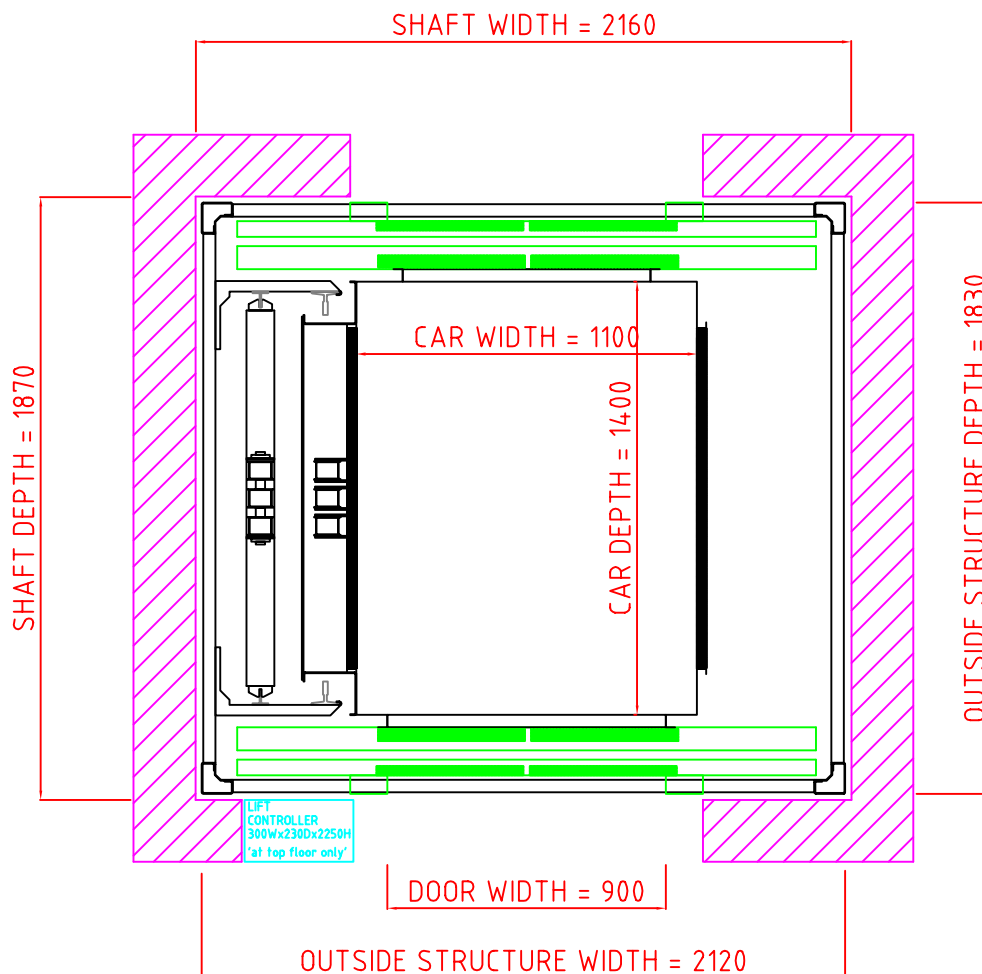

## ULTRA 630DE-SO-M

### LOW-RISE COMMERCIAL LIFT

Capacity	630Kg – 8 persons
Max. Travel	18m / 6 levels
Pit Depth	900mm
Headroom	3300mm
Speed	0.63 m/s or 1.0 m/s
Doors	900mm x 2000mm – side opening

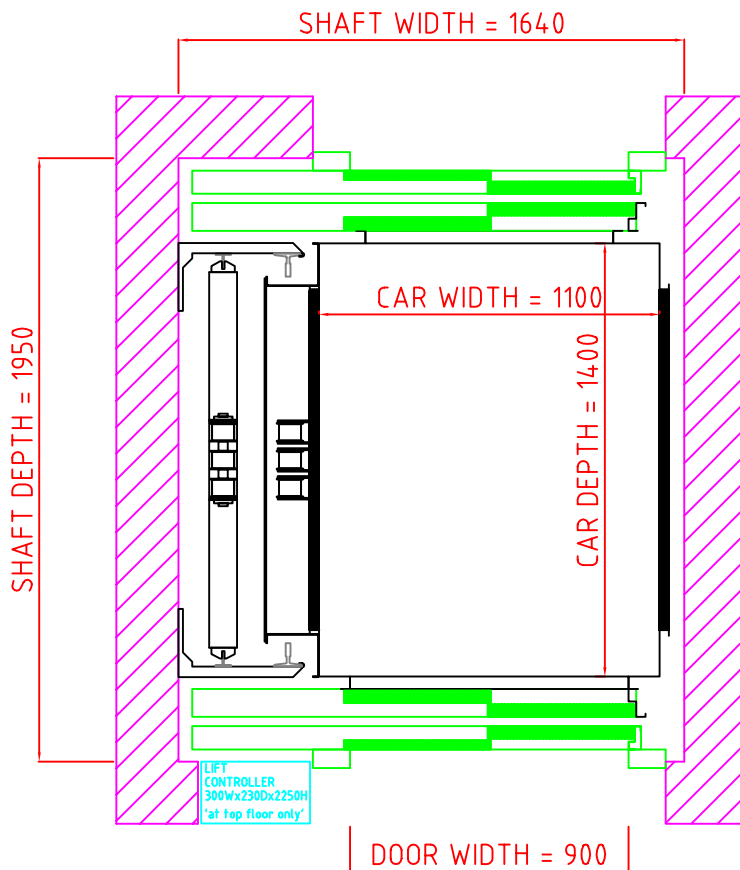

## ULTRA 630DE-SO-ST

### LOW-RISE COMMERCIAL LIFT WITH SUPPORTING STRUCTURE

Capacity	630Kg – 8 persons
Max. Travel	18m / 6 levels
Pit Depth	900mm
Headroom	3300mm
Speed	0.63 m/s or 1.0 m/s
Doors	900mm x 2000mm – side opening

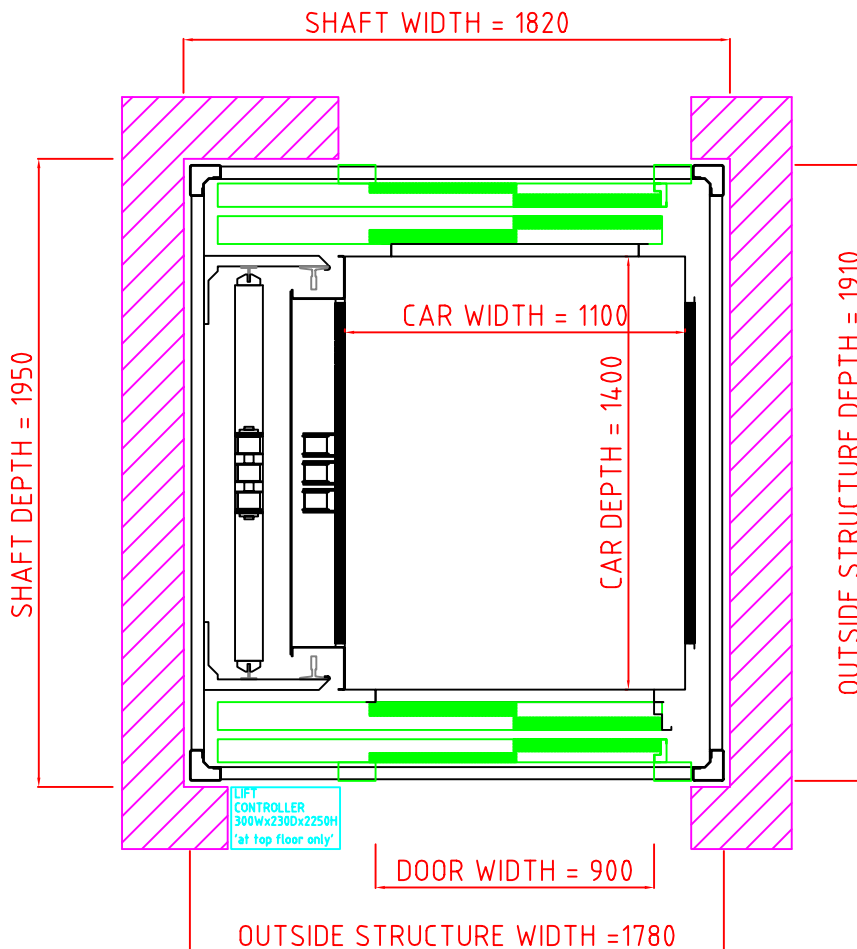

# ULTRA 630DE

## SHAFT ELEVATION

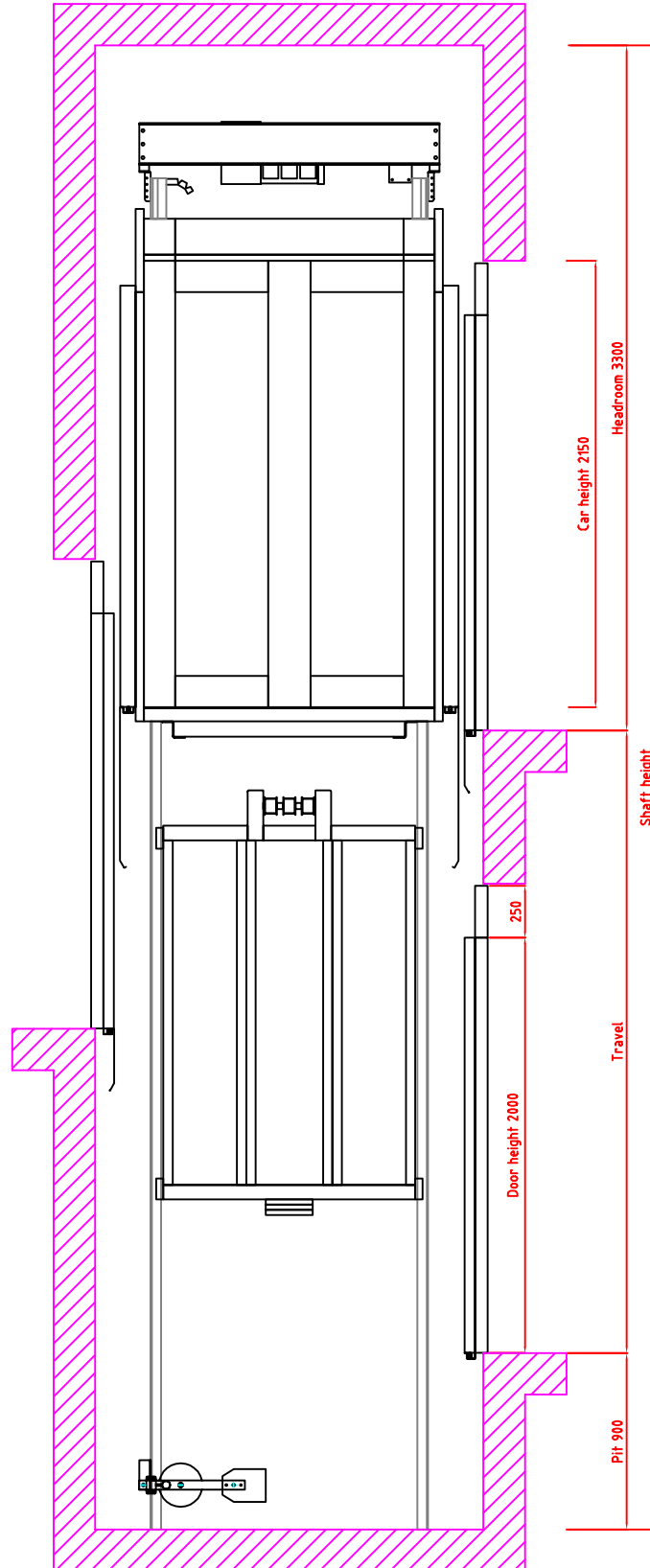

## ULTRA 630DE

### MAXIMUM PIT LOADINGS

- A – 2221Kg
- B – 2504Kg
- C – 3771kg
- D – 696kg
- E – 713Kg

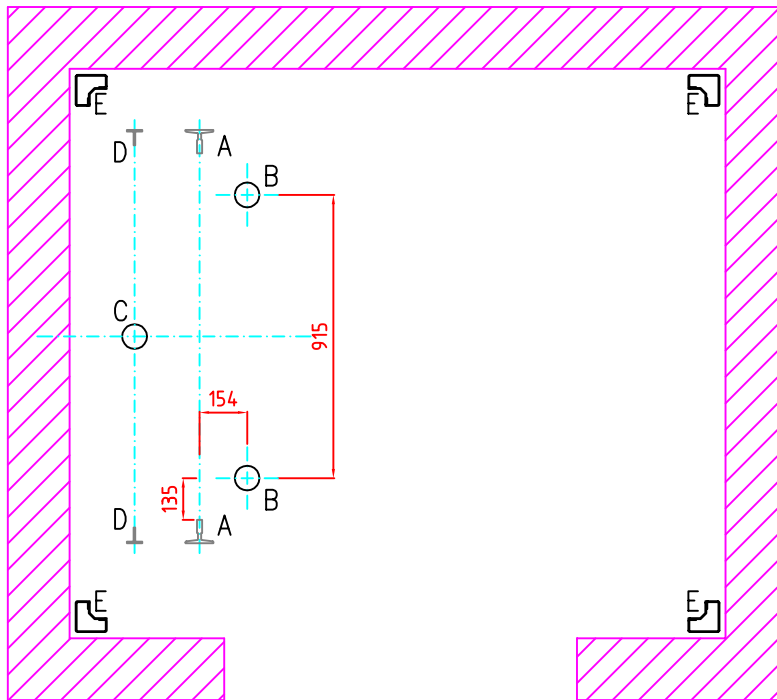

(loads 'E' only apply in case of metal supporting structure)